

THERMACUT® REPLACEMENT PARTS SUITABLE FOR
Hypertherm®
HD®1070/HD®3070 HyDefinition®
PAC®182/PAC®186/PAC®190

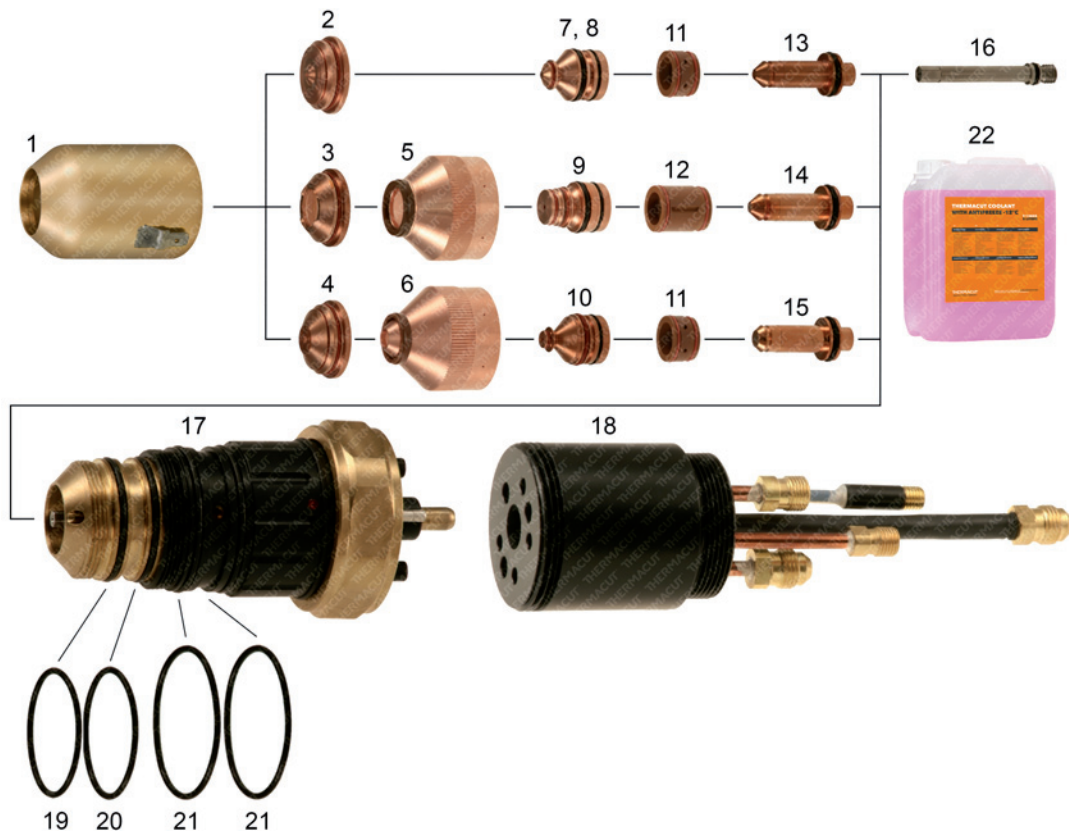

Item	Part No.	Ref. No.	Description	Std. Pkg.	Item	Part No.	Ref. No.	Description	Std. Pkg.
1.	T-2828	020687	Shield Cap, with IHS Tab	1	15.	T-8062	120410	Electrode 100A MS	5
2.	T-8046	020671	Shield 30-50A MS	10	16.	T-8100	120377	Tube, Water Electrode Cooling, PAC®186	1
3.	T-8047	020796	Shield 70A MS/SS	10	17.	T-8063	120349	Torch Main Body, PAC®186	1
4.	T-8048	120273	Shield 100A MS	10	18.	T-8094	028855	Assy, PAC®185/PAC®186, Straight Quick Disconnect	1
5.	T-8050	020795	Inner Retaining Cap 50-70A MS, SS	1	NS	T-10628	T-10628	O-Ring Set For OEM Version	1
6.	T-8051	120266	Inner Retaining Cap 100A MS	1	19.	T-8095	044025	O-Ring	1
7.	T-8053	020645	Nozzle 30A MS	1	20.	T-4028	044026	O-Ring	1
8.	T-8054	020646	Nozzle 50A MS	5	21.	T-4029	044507	O-Ring	1
9.	T-8055	020647	Nozzle 70A MS, SS	5	NS	KT-1073	028499	PAC®186 Cable Leads 6.1m (20')	1
10.	T-8056	120272	Nozzle 100A MS	5	NS	KT-1329	028500	PAC®186 Cable Leads 7.6m (25')	1
11.	T-8057	020637	Swirl Ring 15-100A MS	1	NS	KT-1252	028870	PAC®186 Cable Leads 12.2m (40')	1
12.	T-8058	020789	Swirl Ring 70A MS/SS	2	22.			Coolant Liquid. Details on the page 152, section Accessories.	
13.	T-8060	120111	Electrode 15-30A	5	Different types of cable leads available on request				
14.	T-8061	120112	Electrode 70A MS/SS	5					

NS NOT SHOWN IN THE PICTURE
MS MILD STEEL
SS STAINLESS STEEL

Last update of this page: 18/09/2018. See Revision history for details.

THERMACUT®
 THE CUTTING COMPANY™

WWW.THERMACUT.CZ
 TEL.: +420.556 423 418
 SALES@THERMACUT.CZ

WWW.THERMACUT.DE
 TEL.: +49 (0) 27 39 40 33 0
 INFO@THERMACUT.DE

WWW.THERMACUT.COM
 TEL.: 1-603-542-6715
 CUSTOMERSERVICE@THERMACUT.COM

THERMACUT®, THE CUTTING COMPANY®, FHT-EX®, EX-TRAFIRE®, EX-TRACK®, EX-TRABEAM® AND EX-TRAFLEAME® ARE REGISTERED TRADEMARKS OF THERMACUT, K.S. AND MAY BE REGISTERED IN CZECH REPUBLIC AND/OR OTHER COUNTRIES. ALL OTHER TRADEMARKS ARE PROPERTIES OF THEIR RESPECTIVE OWNERS. THERMACUT IS NO WAY AFFILIATED WITH Hypertherm®.
 MOST THERMACUT PARTS ARE MADE FOR OR BY AN IBC COMPANY. PARTS INDICATED WITH A OEM ARE ORIGINAL PARTS MANUFACTURED BY THE ABOVE NAMED MANUFACTURER AND ARE BEING RESOLD BY THERMACUT. THERMACUT RESERVES THE RIGHT TO SUBSTITUTE OEM PARTS IN PLACE OF THERMACUT PARTS.
 VALID FROM NOVEMBER 2020 • PREVIOUS VERSION IS NO LONGER VALID. • © COPYRIGHT 2020 BY THERMACUT® CZECH REPUBLIC. ALL RIGHTS RESERVED.